

DIVERGE-ENT

Installation and Commissioning Certificate Aerial Acrobatic and Circus Training System

Organisation: **Victorian Department of Education – Performing Arts Unit**

Address: 83-85 Cromwell St, Collingwood VIC 3066

Installation Date: April 2025

Recertification due Date: April 2026

Installation carried out by: Airsho Pty Ltd ABN: 87 131 972 257
PO Box 250 WARRANDYTE VIC 3113 AUSTRALIA

License to perform high risk work: Advanced Rigging # 0001375321 02

Relevant Australian Standards: DESIGN REQUIREMENTS SHALL COMPLY WITH

- AS 1170.0:2002 Structural Design Actions, Part 0, General Principles
- AS 1170.1:2002 Structural Design Actions, Part 1, Permanent, Imposed and Other Actions
- AS 1170.2:2012 Structural Design Actions, Part 2, Wind Actions
- AS 4100:2020 Steel Structures

This document created April 2025 is to certify that the acrobatic circus training system located at the Performing Arts Unit in Cromwell st Collingwood has been designed, installed and commissioned to the relevant Australian standards and is suitable for the commencement of acrobatic training. In accordance with relevant Australian standards this system **must be inspected annually**.

This system has been designed and engineered for use under the following load scenario and should be considered with the relevant engineering documentation provided.

Maximum of 500kn per point inclusive. It is understood that the Client will monitor the rigging points with load cells as necessary to ensure that the 500kg dynamic load per point is not exceeded at any time. (The ongoing operational safety procedures, systems and work method statements remain the responsibility of the client)

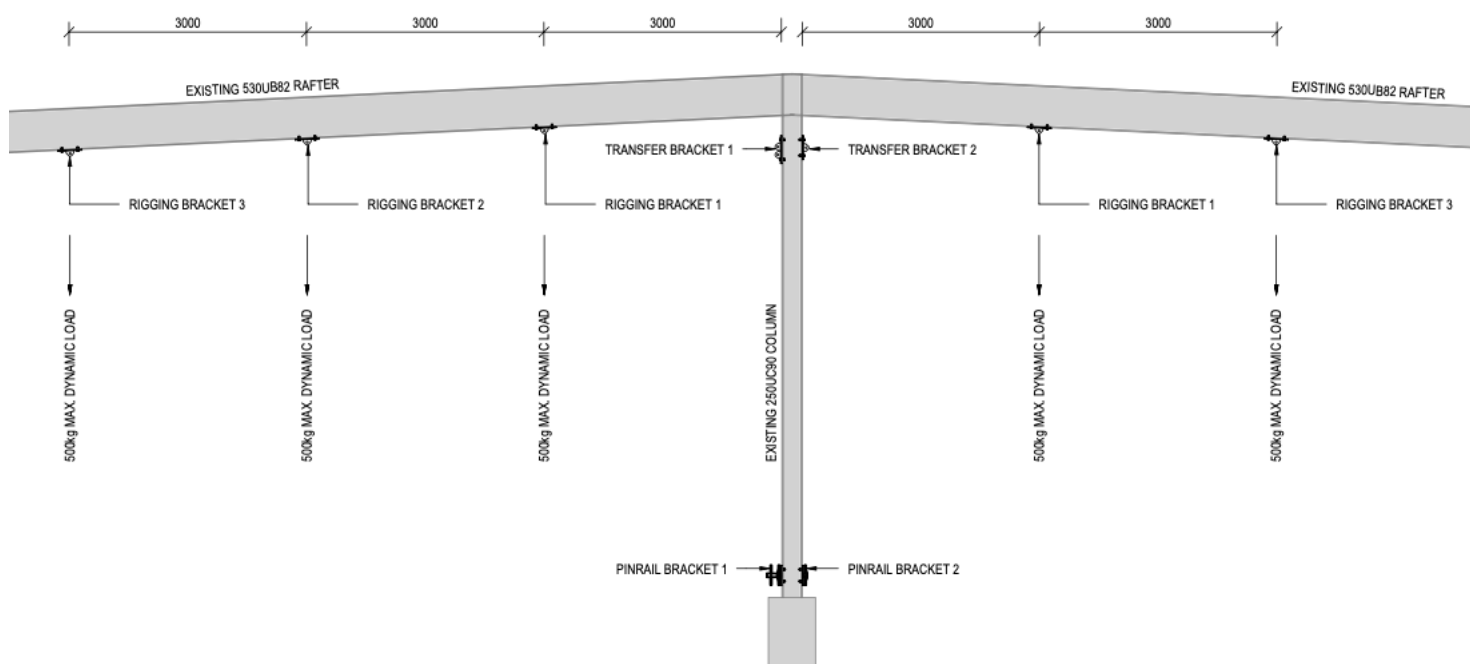

Aerial training systems are high risk and complex systems that should be regularly maintained and operated by trained competent persons. If you notice any issues with the condition or operation of any part of this system please seek immediate assistance.

This certificate should be considered in conjunction with the available supporting engineering documentation provided by Phelan Shilo partners ref# 24-S-133 - Structural Sketches (2024 11 06) - 24-S-133-(SK-001 - SK-004) - 24-S-133-CAL-001 (Rev 0) - 24-S-133-LET-001 (Rev 0)

Prepared by
Mitchell Hunt
0497 175 479
Diverge Entertainment
mitch@diverg-ent.com

DIVERGE-ENT